

plan

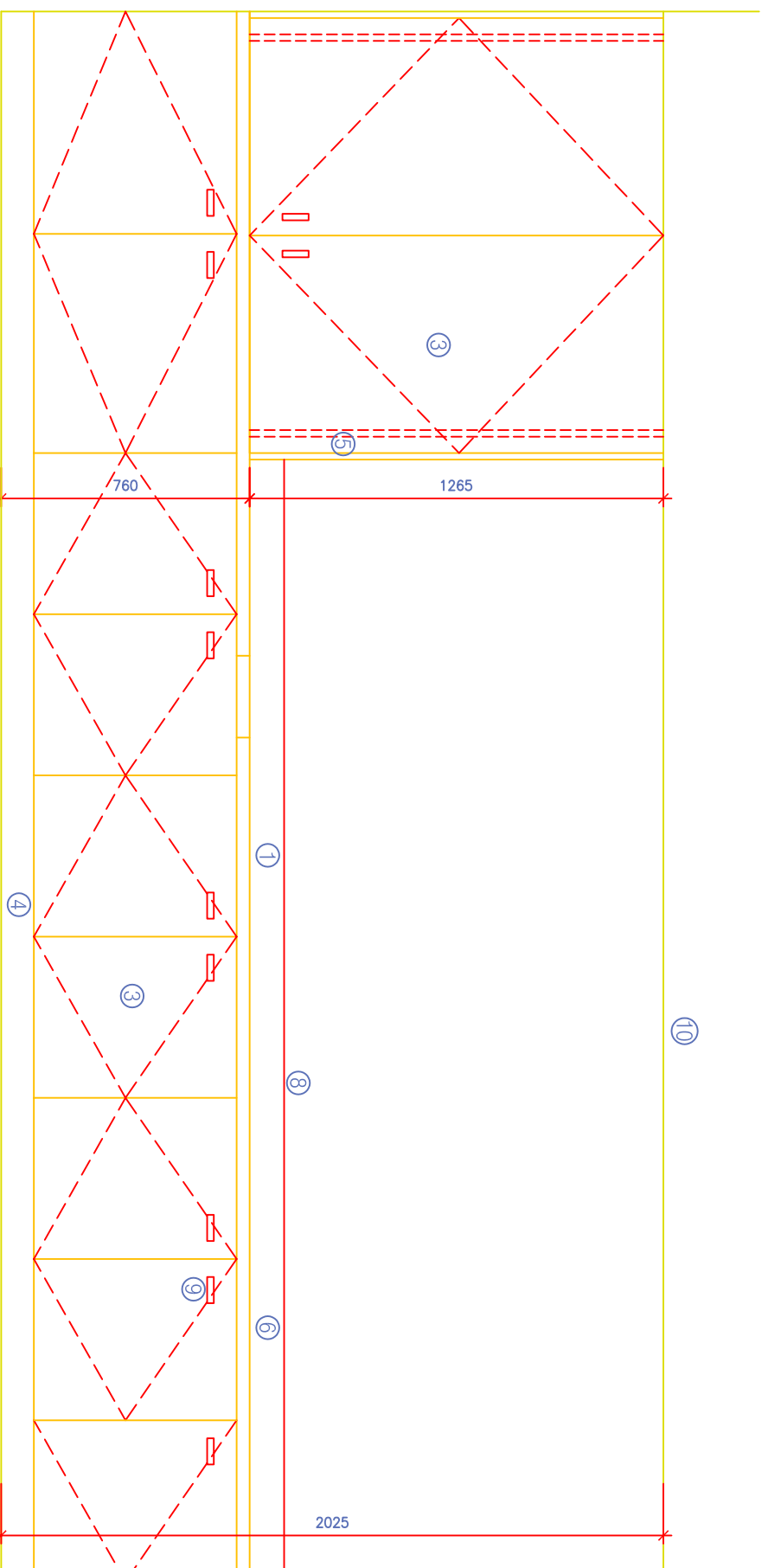

elevation

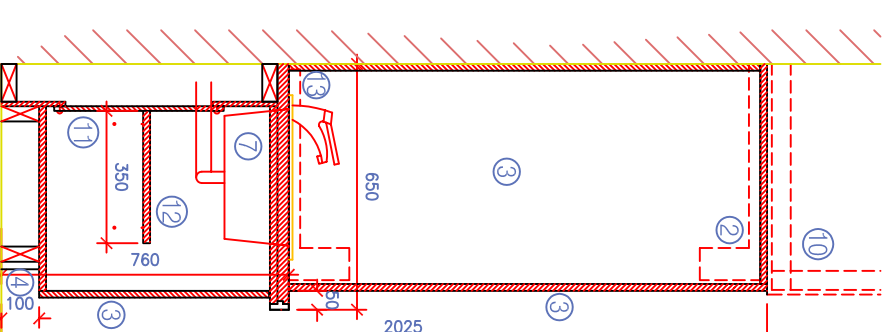

section a-a

- Legend:
- 30 mm thick MDF worktop with decorative high pressure laminate
 - Robust pivot sliding door fitting for hinged and sliding doors - to suit pairs of doors, complete with top and bottom guide channels, concealed hinges and scissor type mechanism - spring assisted. 18 mm thick MDF cupboard doors (lockable), carcass and back panel with decorative high pressure laminate.
 - 100 x 25 mm hardwood plinth on SW battens
 - 50 mm gap between side panels to allow concealment of doors in open position.
 - Worktop extends to create knee space at computer workstation
 - 1000 x 450 mm stainless steel inset sink grade 304 with drainer
 - Dado trunking to M&E consultant spec.
 - Ironmongery: Stainless steel recessed door handles reverse fixed through door. High quality self-closing hinges and high quality cylinder type locks on masterkey system as specified by the school.
 - Plasterboard bulkhead over unit to architect's spec.
 - 12 mm demountable backing panel at sink - as carcass spec.
 - Adjustable shelving on steel brackets plug in - 100 kg capacity per shelf- shelving spec. as carcass
 - Continuous mastic seal to back and side panels/ worktops as single sink unit.

Minimum Standards for materials and finishes:

Core material for worktops, doors and carcasses:
 Dry Fibre Board (MDF) to I.S. EN 622-5 Class E1 formaldehyde content tested to EN 120.
 Moisture resistant board to I.S. EN 622-5 MDF-H, class E1 formaldehyde content tested to EN 120.

Core materials to be finished with plastic laminates to comply with I.S. EN 438, grade HGS/HGP (including vertical panels, shelves and doors).
 Balancing laminate to be used in all cases.

Edges of all laminated panels (if not postformed) to be finished with solid colour laminate (2 mm thickness), PVC or hardwood edges to seal all edges.

Solid timber to comply with IS EN 942, Class J10.
 FSC/PEFC chain of custody certification required for all timber and timber products, including MDF.

Metal frames:
 Generally 60x30 mm mild steel frame with welded end caps and adjustable feet. Epoxy powder coated to selected RAL colour.

Ironmongery:
 Stainless steel door handles, reversed fixed through doors. High quality stainless steel or nickel plated self-closing hinges (180°) and high quality cylinder style lock on masterkey system to suit the school's requirements.

Hardwood plinth size to be coordinated with skirting height in rooms.

Note:
 Alternative materials and finishes of equal or higher specification and performance are permitted.
 Drawings to be read in conjunction with specification.

MEETING ROOM UNIT - MTR

REVISION:	CHECKED BY :	-
REMARKS:	PREPARED BY:	-
SCALE:	DATE:	JUNE '10
1:20	DRG No.:	022

