

plan (scale 1:10)

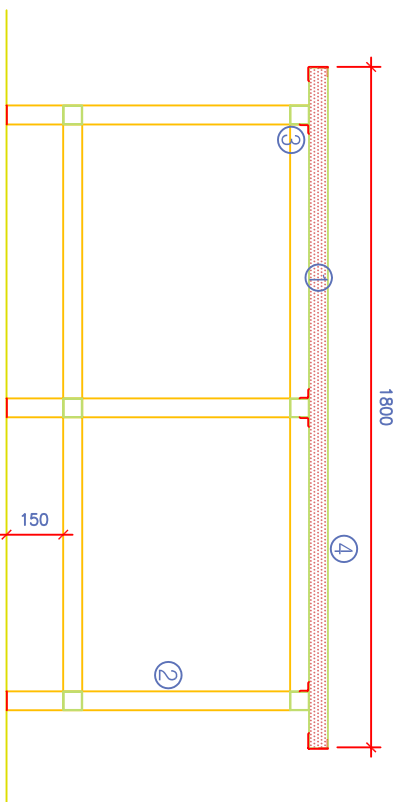

section a-a

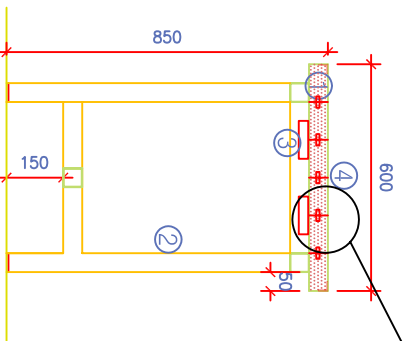

section b-b

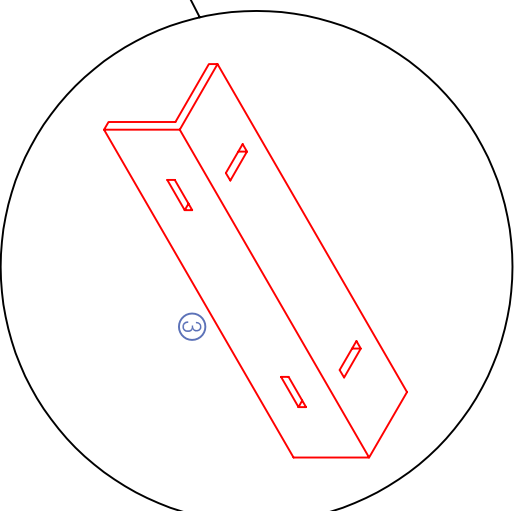

Legend:

1. 100 x 75 mm softwood planks joined with 40 x 12 mm ply loose tongues. Sealed to specification.
2. Welded frame of 50 x 50 x 4 mm hollow section steel with rubber or plastic inserts to legs
3. 25 x 25 x 3 mm steel fixing angle 100 mm long with slotted holes.
4. 1.5 mm stainless steel sheet folded and fixed to table top. Table to have rounded corners min 15 mm radius.
5. 25 x 25 x 3 mm steel angle edge trim recessed into table top. Corners formed as one piece by welding with 15 mm corner radius. 3 mm gap between corner piece and adjacent angle as provision for differential movement in two directions.

Note: steel frame to be powder coated to selected RAL colour.

Minimum Standards for materials and finishes:

Core material for worktops, doors and carcasses:
 Dry Fibre Board (MDF) to I.S. EN 622-5 Class E1 formaldehyde content tested to EN 120.
 Moisture resistant board to I.S. EN 622-5 MDF-H, class E1 formaldehyde content tested to EN 120.

Core materials to be finished with plastic laminates to comply with I.S. EN 438, grade HGS/HGP (including vertical panels, shelves and doors).
 Balancing laminate to be used in all cases.

Edges of all laminated panels (if not postformed) to be finished with solid colour laminate (2 mm thickness), PVC or hardwood edges to seal all edges.

Solid timber to comply with IS EN 942, Class J10.
 FSC/PEFC chain of custody certification required for all timber and timber products, including MDF.

Metal frames:
 Generally 60X30 mm mild steel frame with welded end caps and adjustable feet. Epoxy powder coated to selected RAL colour.

Ironmongery:
 Stainless steel door handles, reversed fixed through doors. High quality stainless steel or nickel plated self-closing hinges (180°) and high quality cylinder style lock on masterkey system to suit the school's requirements.

Hardwood plinth size to be coordinated with skirting height in rooms.

Note:
 Alternative materials and finishes of equal or higher specification and performance are permitted.
 Drawings to be read in conjunction with specification.

FURNACE/SOLDERING BENCH - MFB		SCALE:	1:10/1:20
		DRG No:	049
REVISION:	CHECKED BY :	DATE:	JUNE '10
REMARKS:	PREPARED BY:		

