

Note :  
Dimensions not to be scaled from drawing.  
For any discrepancies found consult with design office.  
Copyright © - Cork County Council Architects Dept.  
This drawing to be read in conjunction with all the  
Specification Documents.

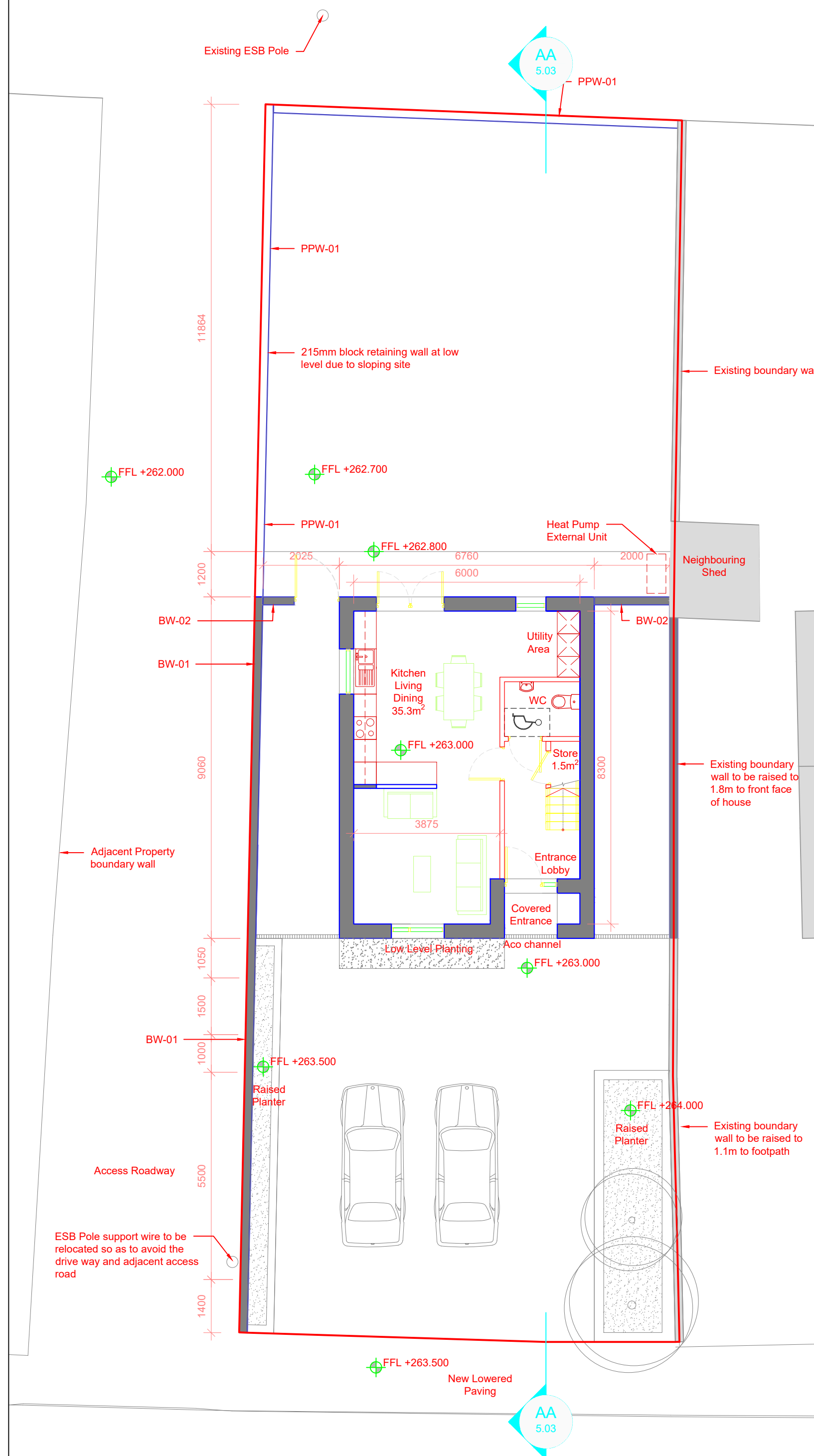

DWELLING TYPE	TARGET GROSS FLOOR AREA (m <sup>2</sup> )	MINIMUM MAIN LIVING ROOM (m <sup>2</sup> )	AGGREGATE LIVING AREA (m <sup>2</sup> )	AGGREGATE BEDROOM AREA (m <sup>2</sup> )	STORAGE (m <sup>2</sup> )
Family Dwellings - 3 or more persons					
3BED/5P House (2 Storey)	92	13	34	32	5
3BED/5P House (Proposed)	94.4	13.6	35.3	34	4.2



01 Ground Floor Plan  
1:100

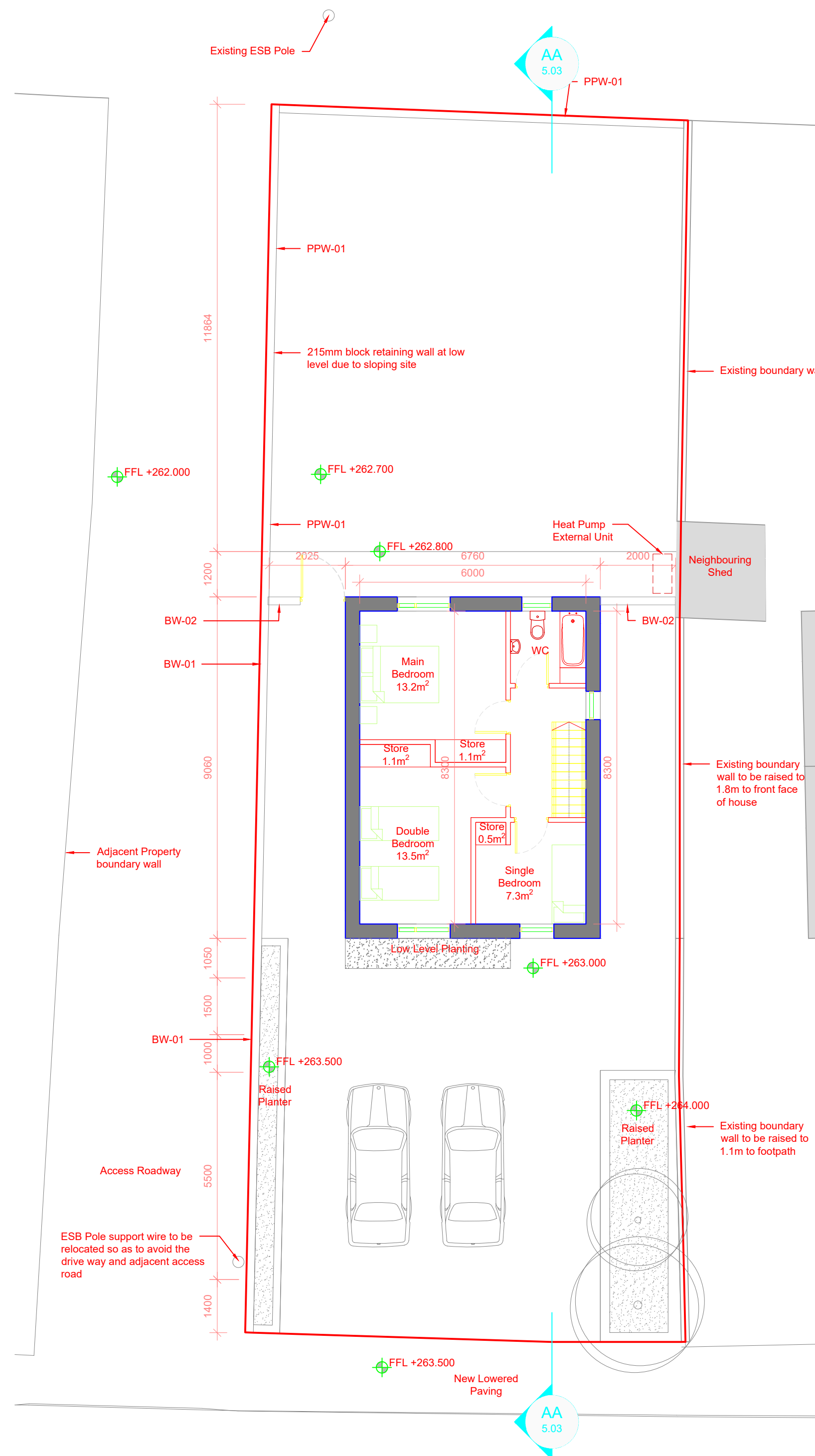

02 First Floor Plan  
1:100

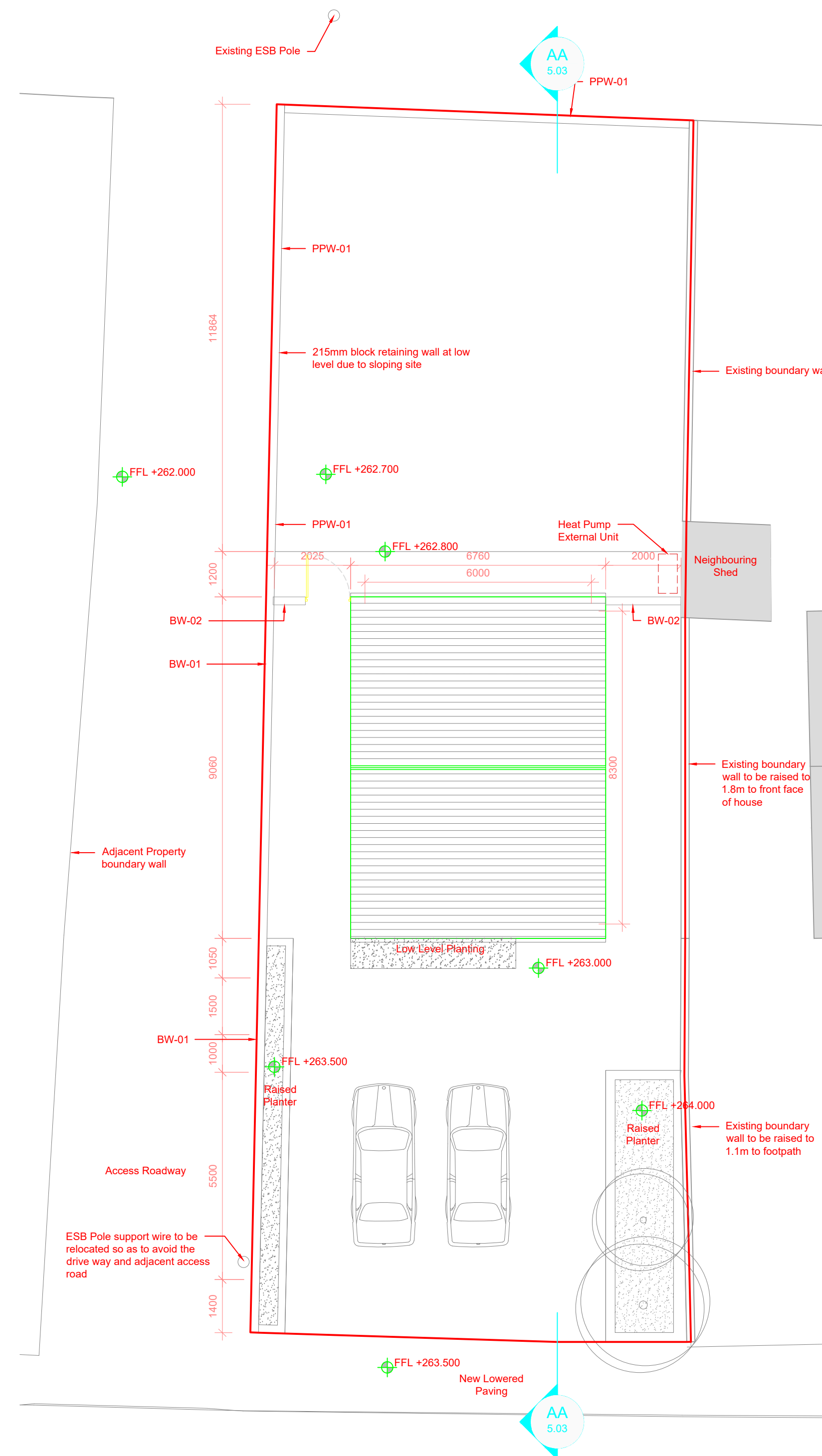

03 Roof Plan  
1:100

B	Issued for Part 8 Planning	20-10-2020
A	Issued for Stage 1 Submission	21-03-2019
Rev / Issue No.	Revision / Issue Description	Date
Project Stage:	Stage 2 - Part 8 Planning	

Job Title: Lyre Glenview House 2A

**Architects Department**  
Housing Directorate  
County Hall, Cork  
Tel: (021) 4285430  
e-mail: architects@corkcoco.ie  
Senior Architect: Ruth Henry



Drawing Title: **Ground, First, Roof Floor Plans**  
General Arrangements

Design Team:	Date: Oct 2020	Dwg. No.
Architect: R.Fenton	Scale: 1:100	5.00
Technician:	Sheet: A1	
Surveyor: R.Brosnan	Stage ID: SI	

Job No. ATSI/N/2017/024

