

ELEVATION: A - A

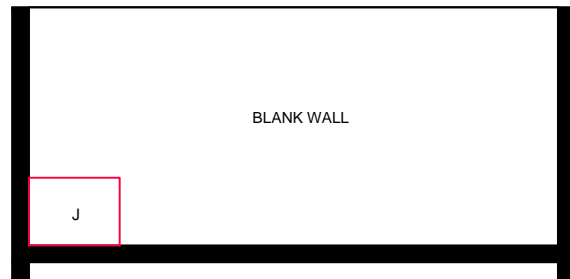

ELEVATION: B - B

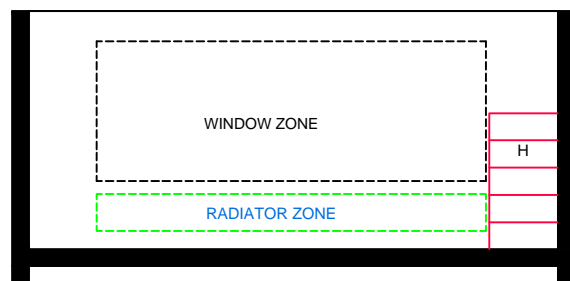

ELEVATION: C - C

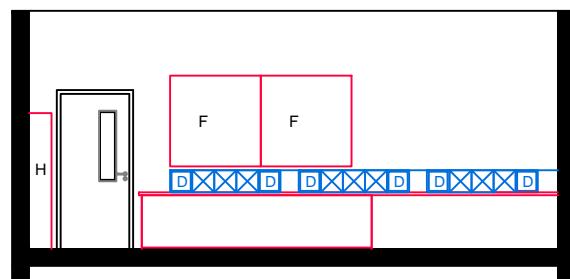

ELEVATION: D - D

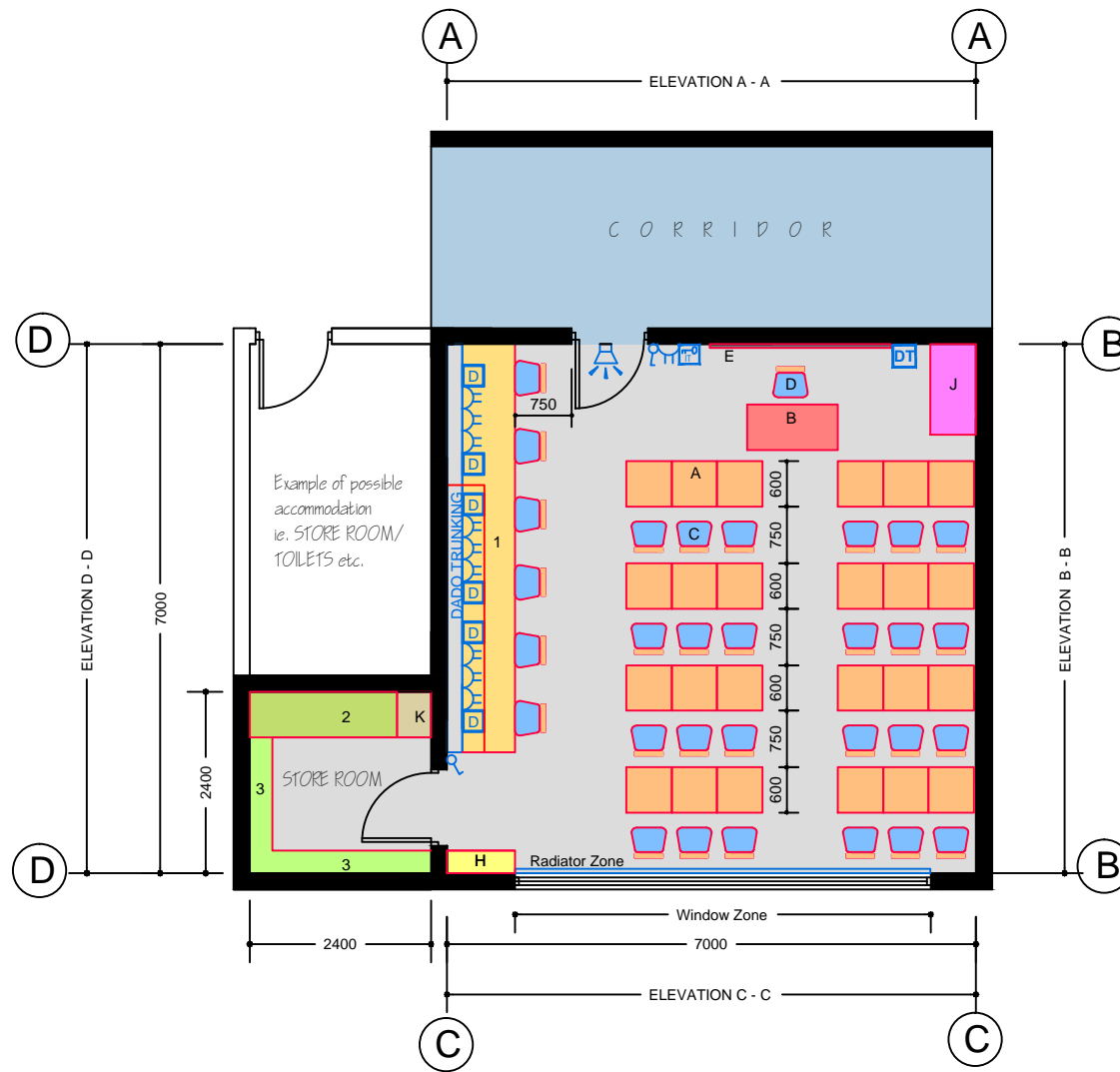

FLOOR PLAN

TECHNICAL NOTES

1. This document provides guidance in relation to the requirements for a Learning Support Room & Store.
2. This document should be read in conjunction with the Technical Guidance Documents (TDGs) as published by the Department of Education & Skills.
3. Refer to Drawing Ref No. RT-ICT-A-100 'Data Projector Installation' for detailed requirements.
4. Final position of network points and associated power outlets shall be above desk/worktop height.
5. Dado trunking shall feed from above in ground floor situations and from ceiling void below if room is located on upper floors.
6. In teaching spaces containing data projectors manual two way switching shall be provided on the row of lights nearest the teaching wall.
7. Control heating to room using 2-port valve and lockable digital type electronic room thermostat.

FURNITURE & EQUIPMENT SCHEDULES

FIXED FURNITURE		Quantity	Code
1	Worktop 5400 x 900 x 710 min high with 5 no underbench storage units	----	CWT
2	3 tier shelving 600 wide		AS 3/6
3	3 tier shelving 300 wide		AS 3/3
LOOSE FURNITURE		Quantity	Code
A	Student's table 600 x 600 x 760 high	24	T2
B	Teacher's desk 1200 x 600 x 760 high	01	T4
C	Student's chair 460 high	24	SIE0
D	Teacher's chair 460 high	01	S5
E	Whiteboard / blackboard 2400 x 1200	01	WB2
F	Pinboard 1200 x 1200	02	PB
H	Library shelving 900 x 300 x 1800 high	01	LSST
I	Student computer chair height adjustable	06	SCC
J	Display chest 1200 x 600 x 850 high (on request)	01	DS
K	Filing cabinet 600 x 450 approx	01	FC1

Appropriate provision of loose furniture for Special Education Needs should be made when required.

EQUIPMENT		Quantity	Code
None			

BUILDING SERVICES LEGEND

BUILDING SERVICES ENGINEERING SYMBOLS	Plan	Elevation
Light Switches	♂	♂
Single Switched Socket Outlets	⊕	⊕
Single Switched Socket Outlets (under worktop)	⊕	⊕
Cleaner's Socket Outlet (not controlled by isolator)	⊕	⊕
Twin Switched Socket Outlets	⊕	⊕
Water Boiler Point	⊕	⊕
Cooker or Built-in Oven Point	CP	CP
Data Projector Isolating Switch	DP	DP
Single Phase Power Supply	1P	1P
3 Phase Power Point	3P	3P
Mechanical Ventilation Power Point	MV	MV
Key Operated Isolating Switch on ICT Installation only	IS	IS
Key Operated Isolator/ knockout Button on Electrical Supply	IS	IS
Emergency Knockout Button on Electrical Supply	IS	IS
Gas Pressure Proving System Control Panel	IS	IS
Emergency Knockout Button on Gas Supply	IS	IS
PA Loudspeaker	IS	IS
Telephone Point	IS	IS
Network Point	IS	IS
Projector Audio Faceplate (PAF)	PAF	PAF
Sub-distribution Board (possible location)	SDB	SDB
Dado Rail Trunking	DT	DT
Dado Trunking (vertical drop/ rise)	DT	DT
Radiator	RADIATOR ZONE	RADIATOR ZONE

- GENERAL NOTES:**
1. This drawing is for information and reference only, designers are responsible for co-ordination issues and compliance with Building Regulations.
 2. Doors shall provide 850 mm clear opening width, except where indicated otherwise.
 3. Do not scale the drawing. Use figured dimensions only. All dimensions given are in millimetres.
 4. All room dimensions are "internal dimensions".
 5. Area = net internal area of the room.
 6. All elevations are internal room elevations.
 7. Any discrepancies between this document and other documents shall be reported to the Department.

POST-PRIMARY SCHOOL ROOM LAYOUTS:

LEARNING SUPPORT ROOM & STORE (55 m²)

DRG NO: RT - 005.1	ISSUE NO: 02	SCALE: 1: 100 @ A3	DATE: Sept 2011
------------------------------	------------------------	------------------------------	---------------------------

**AN ROINN OIDEACHAIS AGUS SCILEANNA
THE DEPARTMENT OF EDUCATION AND SKILLS**

Planning and Building Unit

