

ELEVATION:A - A

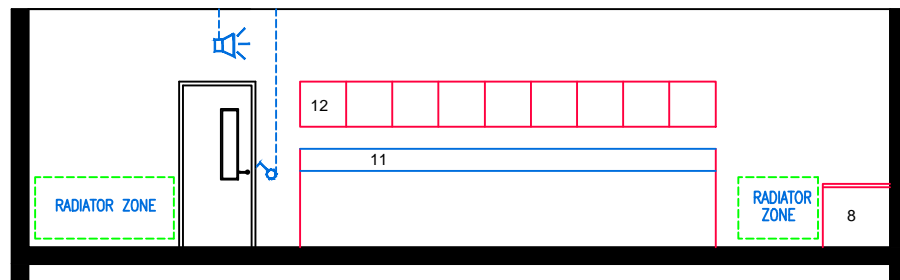

ELEVATION:B - B

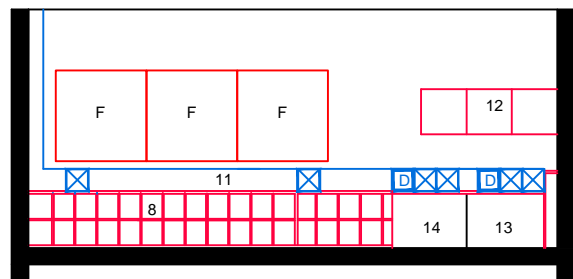

ELEVATION:C - C

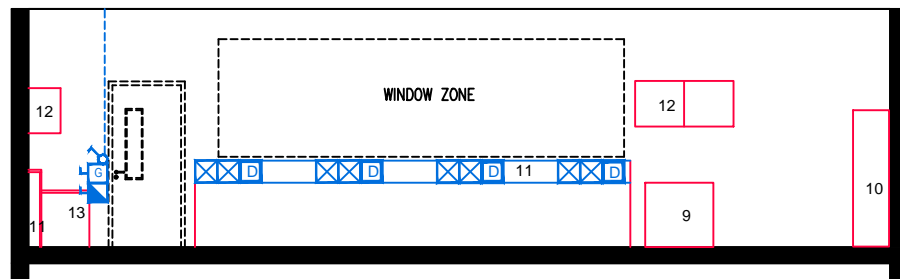

ELEVATION:D - D

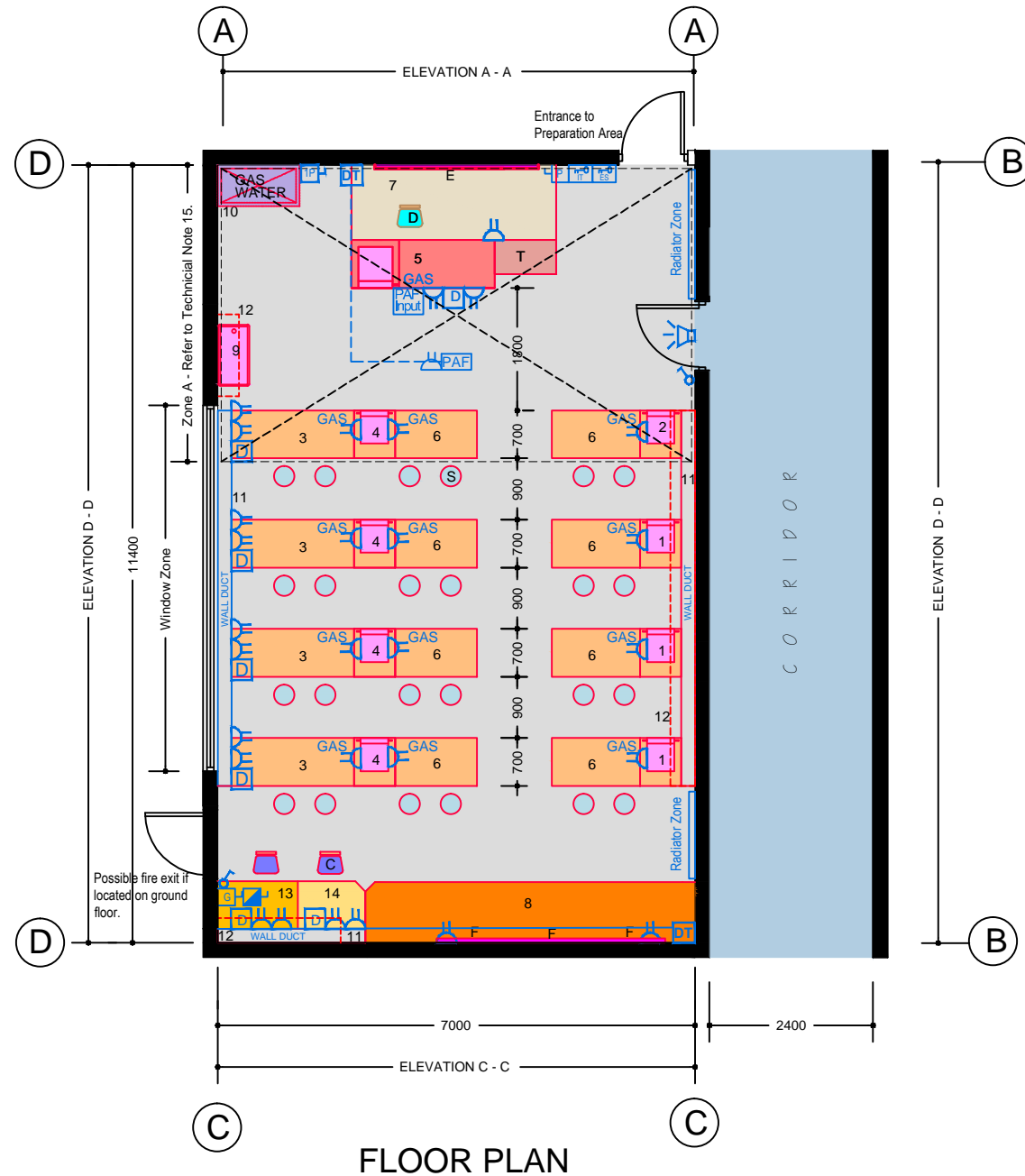

FLOOR PLAN

TECHNICAL NOTES

1. This document provides guidance in relation to the requirements for a Science Laboratory.
2. This document should be read in conjunction with the Technical Guidance Documents (TDGs) as published by the Department of Education & Skills.
3. Refer to Drawing Ref No. RT-ICT-A-100 'Data Projector Installation' for detailed requirements.
4. Final position of network points and associated power outlets shall be above desk/worktop height.
5. Dado trunking shall feed from above in ground floor situations and from ceiling void below if room is located on upper floors.
6. In teaching spaces containing data projectors manual two way switching shall be provided on the row of lights nearest the teaching wall.
7. The exact location of the Data Projector and associated twin outlet and Projector Audio Faceplate (PAF) to be agreed with the Client during design stage and included in the tender documents.
8. Socket outlets, network points and PAF Input are to be located on the teacher's bench and not in the dado railing trunking as outlined in Drawing No. DT ICT-A-100.
9. Control heating to room using 2-port valve and lockable digital type electronic room thermostat.
10. ICT wiring to be run in conduit under the podium to feed the PAF on the teacher's bench etc.
11. Adjacent laboratories should have a common preparation area.
12. There should be a minimum of one secure chemical store 2.9 x 2 m² in each school. It should preferably be located on an outside wall and have natural ventilation, but no windows.
13. If so desired, one lab (physics), may have as part of its preparation area an optics/dark room which should be accessible from the lab only.
14. Where preparation area serves more than one laboratory then an independent pressure proving system is required.
15. Natural light and ventilation required for the area marked in plan as "Zone A".
16. Where plans changes to deep plan adjacent Science Prep Room & Corridor are swapped.

FURNITURE & EQUIPMENT SCHEDULES

FIXED FURNITURE	Quantity	Code
1 Student's pedestal unit 600x700x1020 high with science sink, gas and twin socket	03	PU1
2 Height adjustable pedestal unit as Item 1	01	PU-HA
3 Student's science bench 2400x700x850	04	SSB
4 Students pedestal unit 600x700x1020 high with science sink, gas and twin socket on 2 sides	04	PU2
5 Teacher's science bench 2100x700x850 high with one science sink	01	STB
6 Student's project table (moveable) 1200x700x850 high, top to match science benches	08	SPT
7 Rostrum 3300x1800x150 high	01	R
8 Worktop, length as shown, top to match science benches, to accommodate bag storage units as shown	01	WTB
9 Belfast sink 900x455 (H&C supply)	01	BS
10 Fume cupboard 1200x600 approx	01	FC
11 Wall duct along side of room to accommodate services to science benches. Approx 200 mm wide to match science benches		
12 High level storage with lockable doors		HL6
13 Worktop 900x900x710 mm min. high. Top to match science bench.		CWT
14 Removable worktop 900x900x710. Top as Item 12.		CWT

LOOSE FURNITURE	Quantity	Code
C Students computer chair height adjustable	02	SCC
D Teacher's chair 525 high	01	S5H
E Whiteboard / blackboard with graph panel 2400 x 1200	01	CBS/M
F Pinboard 1200x1200	04	PB
S Student's stool 600 high (stackable)	24	S2H
T Trolley 1055 x 420 x 850 high with lockable castors	01	STS T

Appropriate provision of loose furniture for Special Education Needs should be made as required.

BUILDING SERVICES LEGEND

BUILDING SERVICES ENGINEERING SYMBOLS	Plan	Elevation
Light Switches	⊕	⊕
Single Switched Socket Outlets	⊕	⊕
Single Switched Socket Outlets (under worktop)	⊕	⊕
Cleaner's Socket Outlet (not controlled by isolator)	⊕	⊕
Twin Switched Socket Outlets	⊕	⊕
Water Boiler Point	⊕	⊕
Cooker or Built-in Oven Point	⊕	⊕
Data Projector Isolating Switch	⊕	⊕
Single Phase Power Supply	⊕	⊕
3 Phase Power Point	⊕	⊕
Mechanical Ventilation Power Point	⊕	⊕
Key Operated Isolating Switch on ICT Installation only	⊕	⊕
Key Operated Isolator/ knockout Button on Electrical Supply	⊕	⊕
Emergency Knockout Button on Electrical Supply	⊕	⊕
Gas Pressure Proving System Control Panel	⊕	⊕
Emergency Knockout Button on Gas Supply	⊕	⊕
PA Loudspeaker	⊕	⊕
Telephone Point	⊕	⊕
Network Point	⊕	⊕
Projector Audio Faceplate (PAF)	⊕	⊕
Sub-distribution Board (possible location)	⊕	⊕
Dado Rail Trunking	⊕	⊕
Dado Trunking (vertical drop/ rise)	⊕	⊕
Radiator	⊕	⊕

GENERAL NOTES:

1. This drawing is for information and reference only, designers are responsible for co-ordination issues and compliance with Building Regulations.
2. Doors shall provide 850 mm clear opening width, except where indicated otherwise.
3. Do not scale the drawing. Use figured dimensions only. All dimensions given are in millimetres.
4. All room dimensions are "internal dimensions".
5. Area = net internal area of the room.
6. All elevations are internal room elevations.
7. Any discrepancies between this document and other documents shall be reported to the Department.

POST-PRIMARY SCHOOL ROOM LAYOUTS:

**SCIENCE LABORATORY
(80 m²) Option 1.**

DRG NO: RT - 011.1	ISSUE NO: 02	SCALE: 1: 100 @ A3	DATE: Sept 2011
------------------------------	------------------------	----------------------------------	---------------------------

**AN ROINN OIDEACHAIS AGUS SCILEANNA
THE DEPARTMENT OF EDUCATION AND SKILLS**

Planning and Building Unit

