

ELEVATION:A - A

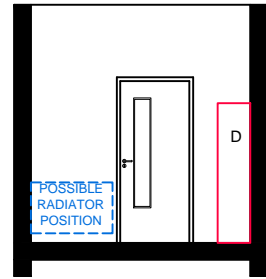

ELEVATION:B - B

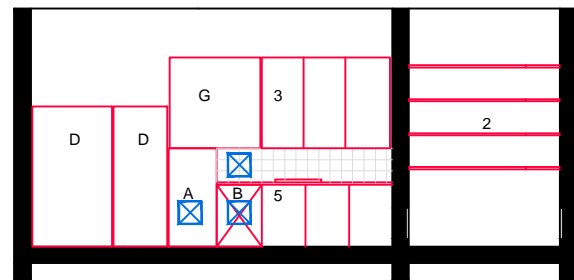

ELEVATION:C - C

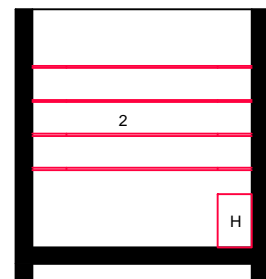

ELEVATION:D - D

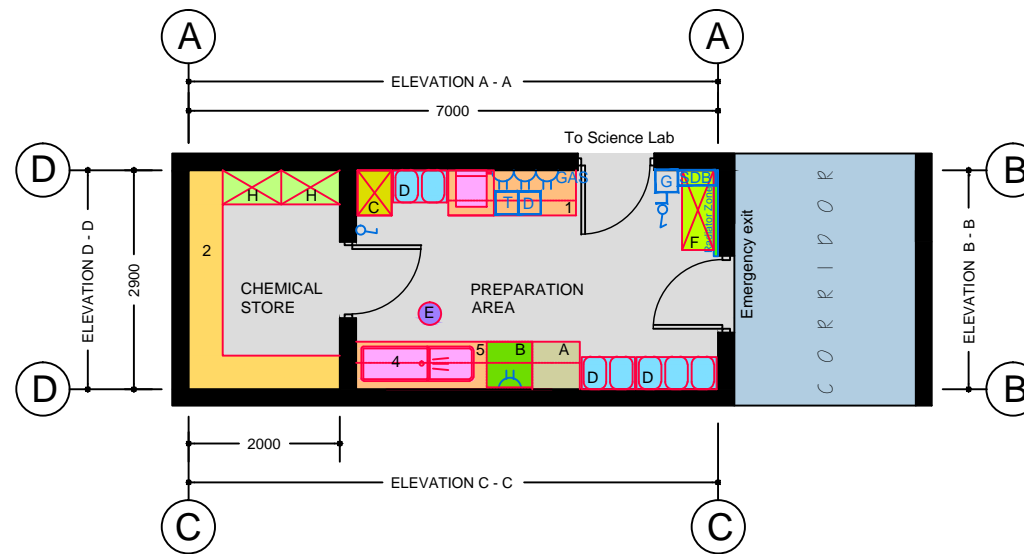

FLOOR PLAN

TECHNICAL NOTES

1. This document provides guidance in relation to the requirements for a Science Preparation Room.
2. This document should be read in conjunction with the Technical Guidance Documents (TDGs) as published by the Department of Education & Skills.
3. Final position of network points and associated power outlets shall be above desk/worktop height.
4. Dado trunking shall feed from above in ground floor situations and from ceiling void below if room is located on upper floors.
5. Small radiator with a Thermostatic Radiator Valve to be provided in secure chemical store.
6. Science laboratories should normally be in pairs with shared preparation room (RT 11.4 or 11.5) Layout RT 11.3 is for a single laboratory only.

FURNITURE & EQUIPMENT SCHEDULES

FIXED FURNITURE		Quantity	Code
1	Base unit 600x900 high lengths as shown. Science sink, gas and sockets on wall with hot and cold water supply.	01	WTS
2	4 tier shelving 450 deep	---	
3	High level presses 1200x300 deep	01	HL12
4	Belfast sink 900x460 (hot & cold)	01	BS
5	Base unit	01	WTS

Note: all worktops in this room to match science bench worktops.

LOOSE FURNITURE		Quantity	Code
C	Filing cabinet	01	FC1
D	Tray Storage System with plastic trays 420D x 1055W x 1850H	01	STS1
	Tray Storage System with plastic trays 420D x 710W x 1850H	02	STS2
E	Stool 600 high	01	S2H
F	Trolley for plastic trays 430D x 1055W x 850H	01	STS T
G	Pinboard 1200x1200	01	PB

Loose furniture is shown only where it may have an impact on services. Appropriate provision of loose furniture for Special Education Needs should be made when required.

EQUIPMENT		Quantity	Code
A	Fridge/freezer 600x600x1500 high	01	FFR
B	Underbench dishwasher 600x600	01	DW
H	Storage unit for flammable and corrosive substances 450 mm deep x 600 mm wide x 700 mm high	02	SCF

Equipment is shown only where it may have an impact on services. Appropriate provision of loose furniture for Special Education Needs should be made when required.

BUILDING SERVICES LEGEND

BUILDING SERVICES ENGINEERING SYMBOLS		Plan	Elevation
Light Switches		♂	♂
Single Switched Socket Outlets		⊖	⊖
Single Switched Socket Outlets (under worktop)		⊖	⊖
Cleaner's Socket Outlet (not controlled by isolator)		⊖	⊖
Twin Switched Socket Outlets		⊖	⊖
Water Boiler Point		⊖	⊖
Cooker or Built-in Oven Point		CP	CP
Data Projector Isolating Switch		DP	DP
Single Phase Power Supply		1P	1P
3 Phase Power Point		3P	3P
Mechanical Ventilation Power Point		MV	MV
Key Operated Isolating Switch on ICT Installation only		IS	IS
Key Operated Isolator/ knockout Button on Electrical Supply		IS	IS
Emergency Knockout Button on Electrical Supply		IS	IS
Gas Pressure Proving System Control Panel		IS	IS
Emergency Knockout Button on Gas Supply		IS	IS
PA Loudspeaker		IS	IS
Telephone Point		IS	IS
Network Point		IS	IS
Projector Audio Faceplate (PAF)		PAF	PAF
Sub-distribution Board (possible location)		SDB	SDB
Dado Rail Trunking		DT	DT
Dado Trunking (vertical drop/ rise)		DT	DT
Radiator		RADIATOR ZONE	RADIATOR ZONE

- GENERAL NOTES:**
1. This drawing is for information and reference only, designers are responsible for co-ordination issues and compliance with Building Regulations.
 2. Doors shall provide 850 mm clear opening width, except where indicated otherwise.
 3. Do not scale the drawing. Use figured dimensions only. All dimensions given are in millimetres.
 4. All room dimensions are "internal dimensions".
 5. Area = net internal area of the room.
 6. All elevations are internal room elevations.
 7. Any discrepancies between this document and other documents shall be reported to the Department.

POST-PRIMARY SCHOOL ROOM LAYOUTS:

**SCIENCE PREPARATION ROOM
(one laboratory) (21 m²)**

DRG NO: RT - 011.3	ISSUE NO: 02	SCALE: 1: 100 @ A3	DATE: Sept 2011
------------------------------	------------------------	------------------------------	---------------------------

**AN ROINN OIDEACHAIS AGUS SCILEANNA
THE DEPARTMENT OF EDUCATION AND SKILLS**

Planning and Building Unit

