

### TECHNICAL NOTES

1. This document provides guidance in relation to the requirements for a General Office (Option 1)
2. This document should be read in conjunction with the Technical Guidance Documents (TDGs) as published by the Department of Education & Skills.
3. The proposed layout shown on this drawing to be read as an example, rather than a definitive layout.
4. Final position of network points and associated power outlets shall be above desk/worktop height.
5. Dado trunking shall feed from above.
6. Blinds to be provided
7. TRVs to be fitted to radiators
8. Serving hatch should allow visual contact from wheelchair - 750 mm from floor level to bottom of hatch.
9. Loud speaker not required if PA system controls are located in this room.
10. Adequate natural ventilation via high and low level intumescent wall vents and an external vent to atmosphere to be provided in the photocopy room. Mechanical ventilation not required.

### FURNITURE & EQUIPMENT SCHEDULES

FIXED FURNITURE		Quantity	Code
1	Worktop: 800mm typ. width at workstations, otherwise 600mm To be 740mm high		OSW
2	Underdesk storage unit	03	UDS
3	Underdesk pedestal drawer unit	03	UPU
4	Wall unit	01	HL8
5	Reception Counter with split level - to architect's details		
6	Storage Press - 600x800x2100mm	01	OSP

LOOSE FURNITURE		Quantity	Code
A	Pinboard: 1200x1200mm	01	PB
B	Filing Cabinet - 4 drawer: 450mm wide x 600mm deep	03	FC1
E	Secretary Swivel Chair	03	S8
F	Underdesk Safe 470 H x 320 W x 280 mm D	01	SA
G	Fire resistant, reinforced filing cabinet: 500x675x1500mm	01	FC3

Appropriate provision of loose furniture for Special Education Needs should be made when required.

EQUIPMENT		Quantity	Code
None			

### BUILDING SERVICES LEGEND

BUILDING SERVICES ENGINEERING SYMBOLS	Plan	Elevation
Light Switches		
Single Switched Socket Outlets		
Single Switched Socket Outlets (under worktop)		
Cleaner's Socket Outlet (not controlled by isolator)		
Twin Switched Socket Outlets		
Water Boiler Point		
Cooker or Built-in Oven Point		
Data Projector Isolating Switch		
Single Phase Power Supply		
3 Phase Power Point		
Mechanical Ventilation Power Point		
Key Operated Isolating Switch on ICT Installation only		
Key Operated Isolator/ knockout Button on Electrical Supply		
Emergency Knockout Button on Electrical Supply		
Gas Pressure Proving System Control Panel		
Emergency Knockout Button on Gas Supply		
PA Loudspeaker		
Telephone Point		
Network Point		
Projector Audio Faceplate (PAF)		
Sub-distribution Board (possible location)		
Dado Rail Trunking		
Dado Trunking (vertical drop/ rise)		
Radiator		
Door access system controls		

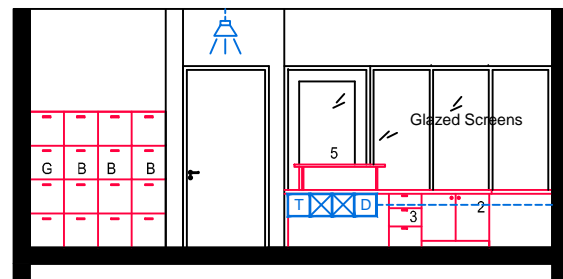

ELEVATION: A-A

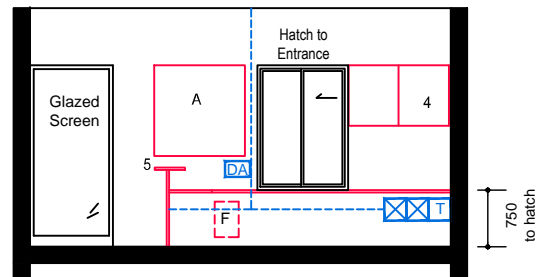

ELEVATION: B-B

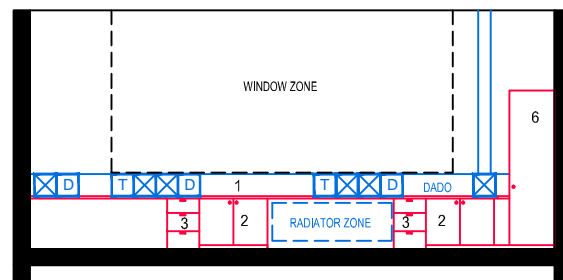

ELEVATION: C-C

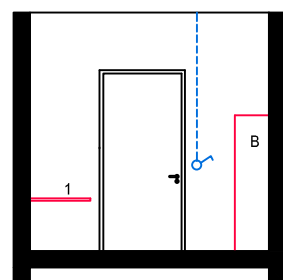

ELEVATION: D-D

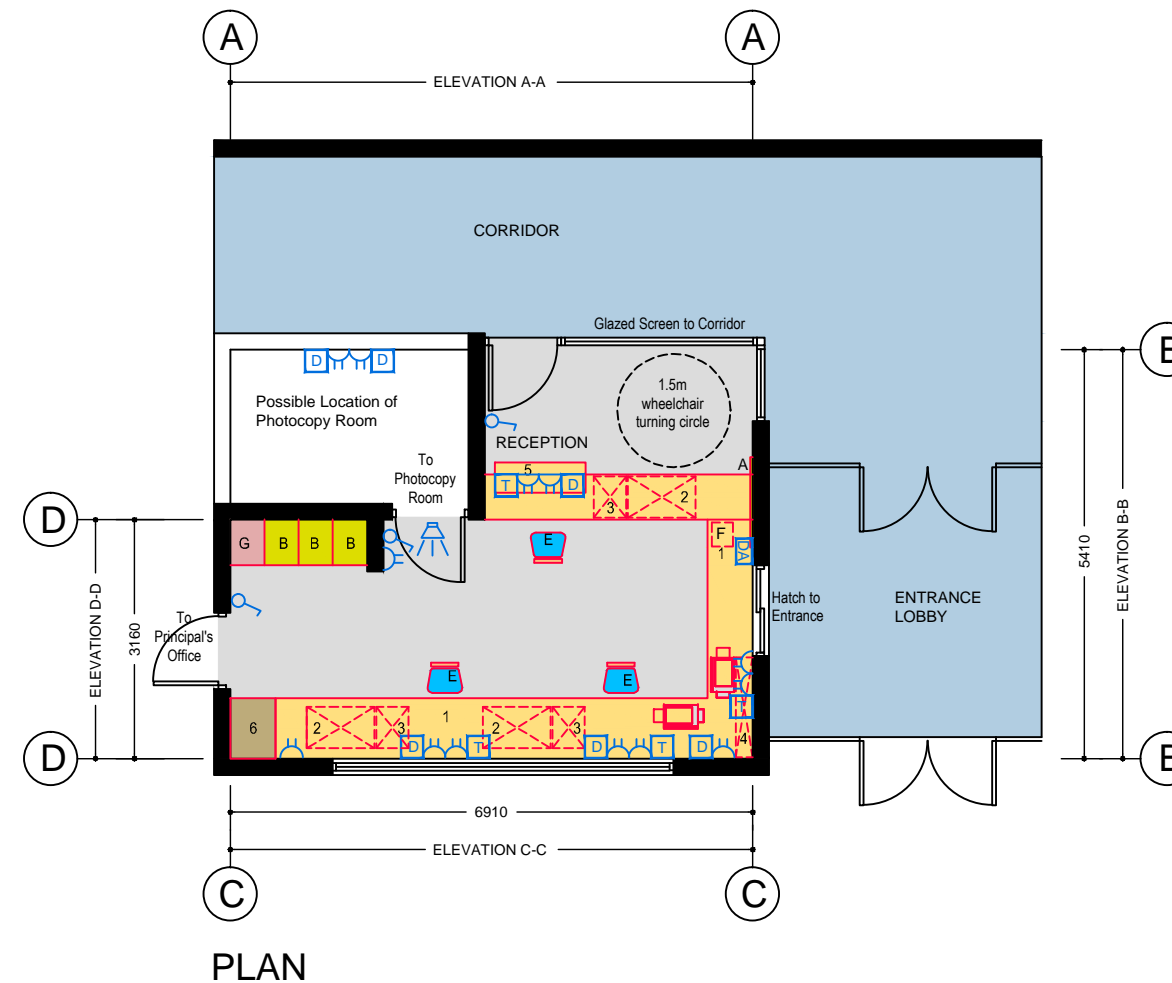

PLAN

#### GENERAL NOTES:

1. This drawing is for information and reference only, designers are responsible for co-ordination issues and compliance with Building Regulations.
2. Doors shall provide 850 mm clear opening width, except where indicated otherwise.
3. Do not scale the drawing. Use figured dimensions only. All dimensions given are in millimetres.
4. All room dimensions are "internal dimensions".
5. Area = net internal area of the room.
6. All elevations are internal room elevations.
7. Any discrepancies between this document and other documents shall be reported to the Department.

#### POST-PRIMARY SCHOOL ROOM LAYOUTS:

## GENERAL OFFICE (30 m<sup>2</sup>) OPTION 1

DRG NO: <b>RT - 026.1</b>	ISSUE NO: <b>01</b>	SCALE: <b>1: 100 @ A3</b>	DATE: <b>Sept 2011</b>
------------------------------	------------------------	------------------------------	---------------------------

## AN ROINN OIDEACHAIS AGUS SCILEANNA THE DEPARTMENT OF EDUCATION AND SKILLS

Planning and Building Unit

