

ELEVATION: A-A

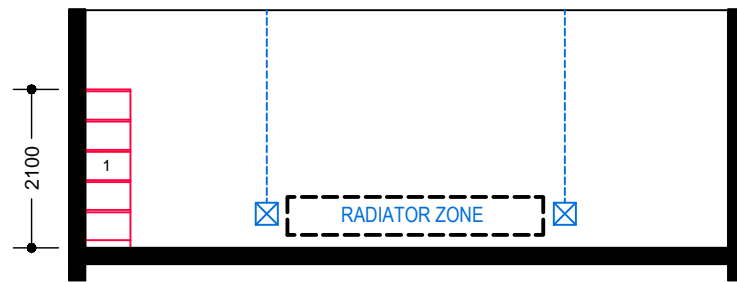

ELEVATION: B-B

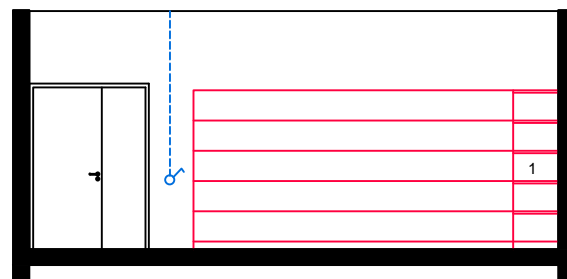

ELEVATION: C-C

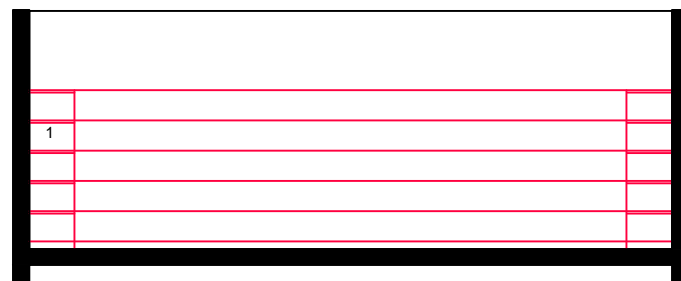

ELEVATION: D-D

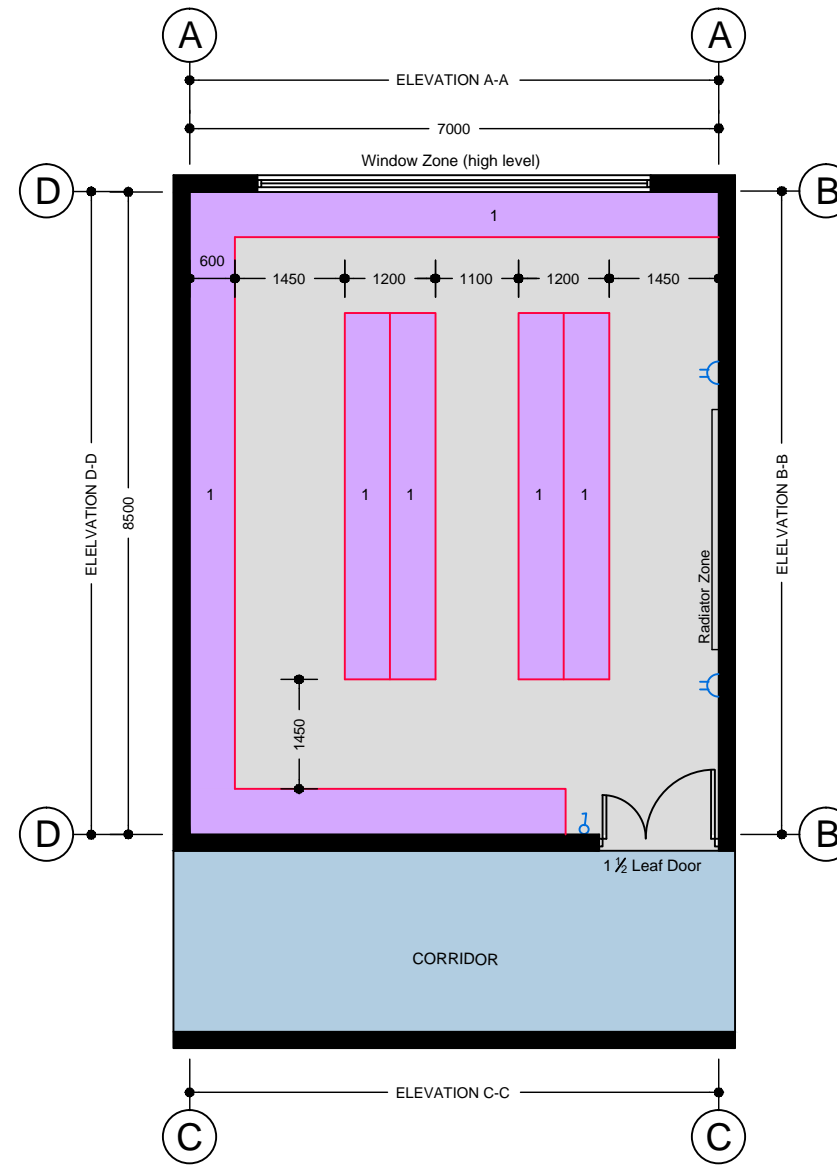

PLAN:

**TECHNICAL NOTES**

1. This document provides guidance in relation to the requirements for a Project Store.
2. This document should be read in conjunction with the Technical Guidance Documents (TDGs) as published by the Department of Education & Skills.
3. Non-slip floor finish required.
4. To be a secure store: windows not desirable.
5. Adequate ventilation to be provided; if windows provided to be high level/narrow.
6. Adequate heating appropriate for store room to be provided.

**FURNITURE & EQUIPMENT SCHEDULES**

**FIXED FURNITURE**

- |   |  |          |      |
|---|--|----------|------|
| 1 | Adjustable Steel shelving system 2210 mm high:<br>12 swg slotted (at 25 mm c/c) angle uprights to take adjustable 950 x 600 mm solid metal shelves with uniform distribution load of 225 kg per shelf - 7 no shelves per bay and steel back and side bracing. Base plate (plinth) to cover gap below bottom shelf. Complete with all cups and bolts supplied and with plastic end caps to uprights. All metal to be epoxy powder coated finish to selected colour. System to be manufactured and installed in accordance with BS 826. Provide lengths as shown on drawing. | Quantity | Code |
|   |  |          |      |

**LOOSE FURNITURE**

None	Quantity	Code

**EQUIPMENT**

None	Quantity	Code

**BUILDING SERVICES LEGEND**

BUILDING SERVICES ENGINEERING SYMBOLS	Plan	Elevation
Light Switches	☐	☐
Single Switched Socket Outlets	⊕	⊕
Single Switched Socket Outlets (under worktop)	⊕	⊕
Cleaner's Socket Outlet (not controlled by isolator)	⊕	⊕
Twin Switched Socket Outlets	⊕	⊕
Water Boiler Point	⊕	⊕
Cooker or Built-in Oven Point	⊕	⊕
Data Projector Isolating Switch	⊕	⊕
Single Phase Power Supply	⊕	⊕
3 Phase Power Point	⊕	⊕
Mechanical Ventilation Power Point	⊕	⊕
Key Operated Isolating Switch on ICT Installation only	⊕	⊕
Key Operated Isolator/ knockout Button on Electrical Supply	⊕	⊕
Emergency Knockout Button on Electrical Supply	⊕	⊕
Gas Pressure Proving System Control Panel	⊕	⊕
Emergency Knockout Button on Gas Supply	⊕	⊕
PA Loudspeaker	⊕	⊕
Telephone Point	⊕	⊕
Network Point	⊕	⊕
Projector Audio Faceplate (PAF)	⊕	⊕
Sub-distribution Board (possible location)	⊕	⊕
Dado Rail Trunking	⊕	⊕
Dado Trunking (vertical drop/ rise)	⊕	⊕
Radiator	⊕	⊕

**GENERAL NOTES:**

1. This drawing is for information and reference only, designers are responsible for co-ordination issues and compliance with Building Regulations.
2. Doors shall provide 850 mm clear opening width, except where indicated otherwise.
3. Do not scale the drawing. Use figured dimensions only. All dimensions given are in millimetres.
4. All room dimensions are "internal dimensions".
5. Area = net internal area of the room.
6. All elevations are internal room elevations.
7. Any discrepancies between this document and other documents shall be reported to the Department.

**POST-PRIMARY SCHOOL ROOM LAYOUTS:**

**PROJECT STORE (Example)  
(60 m<sup>2</sup>)**

DRG NO: <b>RT - 036</b>	ISSUE NO: <b>01</b>	SCALE: <b>1: 100 @ A3</b>	DATE: <b>Sept 2011</b>
----------------------------	------------------------	----------------------------------	---------------------------

**AN ROINN OIDEACHAIS AGUS SCILEANNA  
THE DEPARTMENT OF EDUCATION AND SKILLS**

**Planning and Building Unit**

